

PARTS KIT

119375

RELEASED: 1-27-94
PN/119999-23

FOR "SIERRA" SERIES VALVES

ONLY GENUINE ARO FACTORY REPLACEMENT PARTS SHOULD BE USED TO ASSURE SATISFACTORY PERFORMANCE

ALL DIMENSIONS ARE IN MILLIMETERS

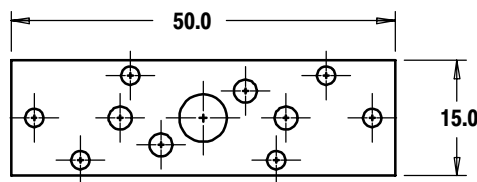

VALVE GASKET

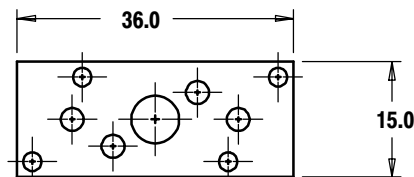

CHECK BLOCK GASKET

ASSEMBLY SCREWS



VALVE TO MANIFOLD
M2.5 X 0.45 / LENGTH = 25
(WITH SPRING LOCK WASHER)



CHECK BLOCK TO MANIFOLD
M2.5 X 0.45 / LENGTH = 20
(WITH SPRING LOCK WASHER)



BLANKING PLATE TO MANIFOLD
M2.5 X 0.45 / LENGTH = 6
(WITH SPRING LOCK WASHER)



RACEWAY
M2.5 X 0.45 / LENGTH = 14
(WITH SPRING LOCK WASHER)

THE ARO CORPORATION • ONE ARO CENTER • BRYAN, OHIO 43506-0151

PH: (419) 636-4242 • FAX (419) 636-2115

©1994 THE ARO CORPORATION • PRINTED IN U.S.A.



Part of worldwide Ingersoll-Rand